

Model 49-231, 49-234, 49-241, 49-251 and 49-286

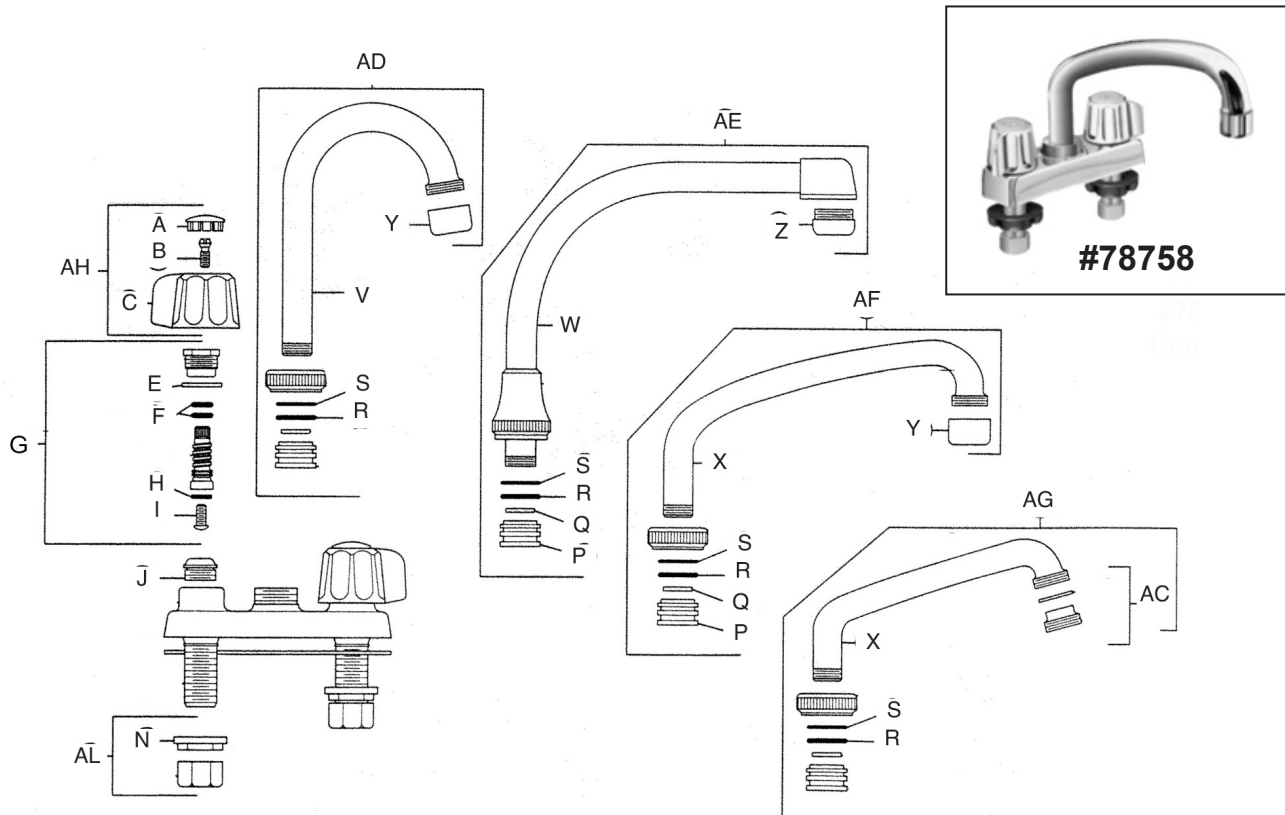

INSTITUTIONAL SCHEMATICS

A	26168	Hot Index Button
	26169	Cold Index Button
B	02108	1/2" X 10-24 S/S Oval Head Handle Screw
C	29566	Old Style Lever Handle
E	09035	Poly Cap Thread Gasket
F	00208	O-Ring
G	30307	Hot Hex Head (OEM) Stem Unit
	303070	Cold Hex Head (OEM) Stem Unit
H	01010	OEM Seat Washer
I	02030	Seat Screw
J	15545	5/8" OD X 20Th Brass Seat
N	99330315	Plastic Locknut
R	00214	3/4" ID X 15/16" OD X 3/32" O-Ring
S	00026	O-Ring 27/32 X 1 X 5/64
V	99311020	Gooseneck Bar Spout S/A w/Aerator
X	99330324	6 In Tube Spout w/ Hose Adapter
Y	14624	2.2 GPM Aerator Reg. 55/64-27 Female
Z	14640	2.2 GPM Aerator Reg. Dual Slotless
AC	16019	Spout To 3/4 Hose or Female Aerator
AD	99311020	Gooseneck Bar Spout S/A w/Aerator
AG	99330324	6" Tube Spout w/ Hose Adapter
AH	99016015	Hot Small Fluted Metal Blade Assembly Handle (CP)
	99016016	Cold Small Fluted Metal Blade Assembly Handle (CP)
AL	99330328	Plastic Locknut & Shank Nut
	78758	Laundry Tray Faucet w/6" Spout (CP)